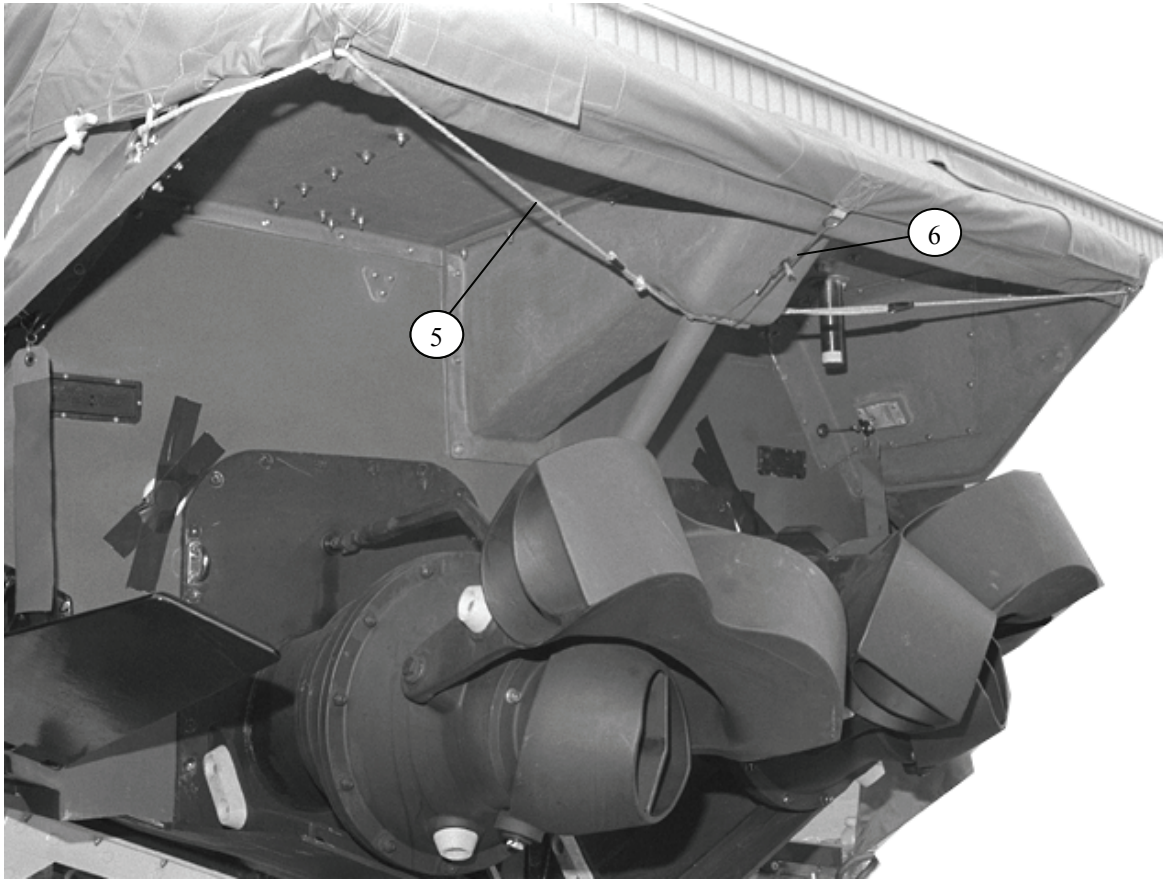

Figure 4-19. Boat Cover Installed (continued)



5. Run a length of 1/2-inch tubular nylon through the D-rings on both sides of the bustle, and tie off, making a three-finger loop. Route the bolt rope through the loops of 1/2-inch tubular nylon and tighten the bolt rope along the edges of the cover on both sides of the boat. Be sure that the cover extends below the edges of the bustle. Form a loop in each running end of the bolt rope.
6. Route a length of type III nylon cord through the looped ends of the bolt rope, around the swim platform support bar, and through the center grommet on the boat cover, forming a continuous loop. Tie off with a cinch knot.

Figure 4-19. Boat Cover Installed (continued)

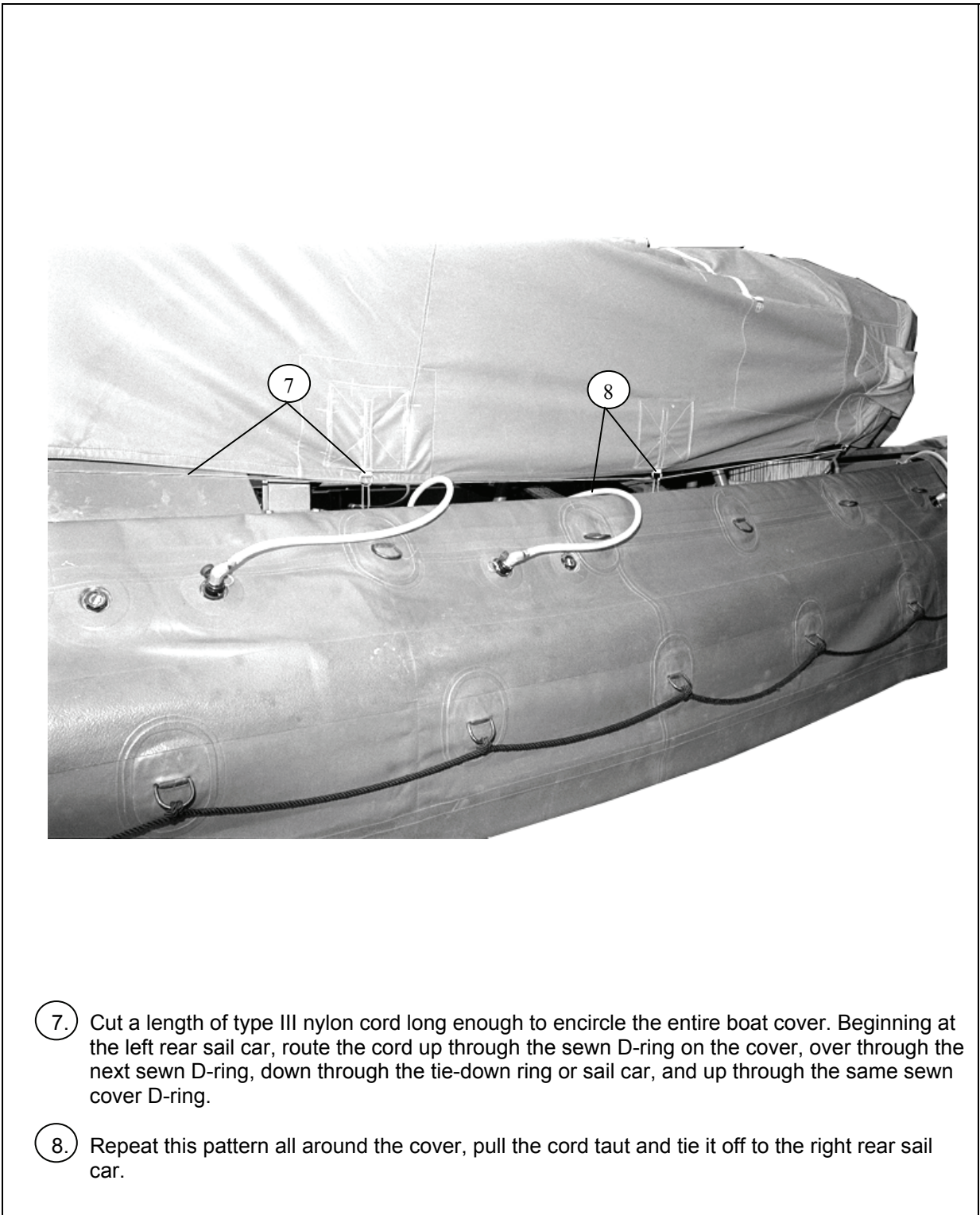
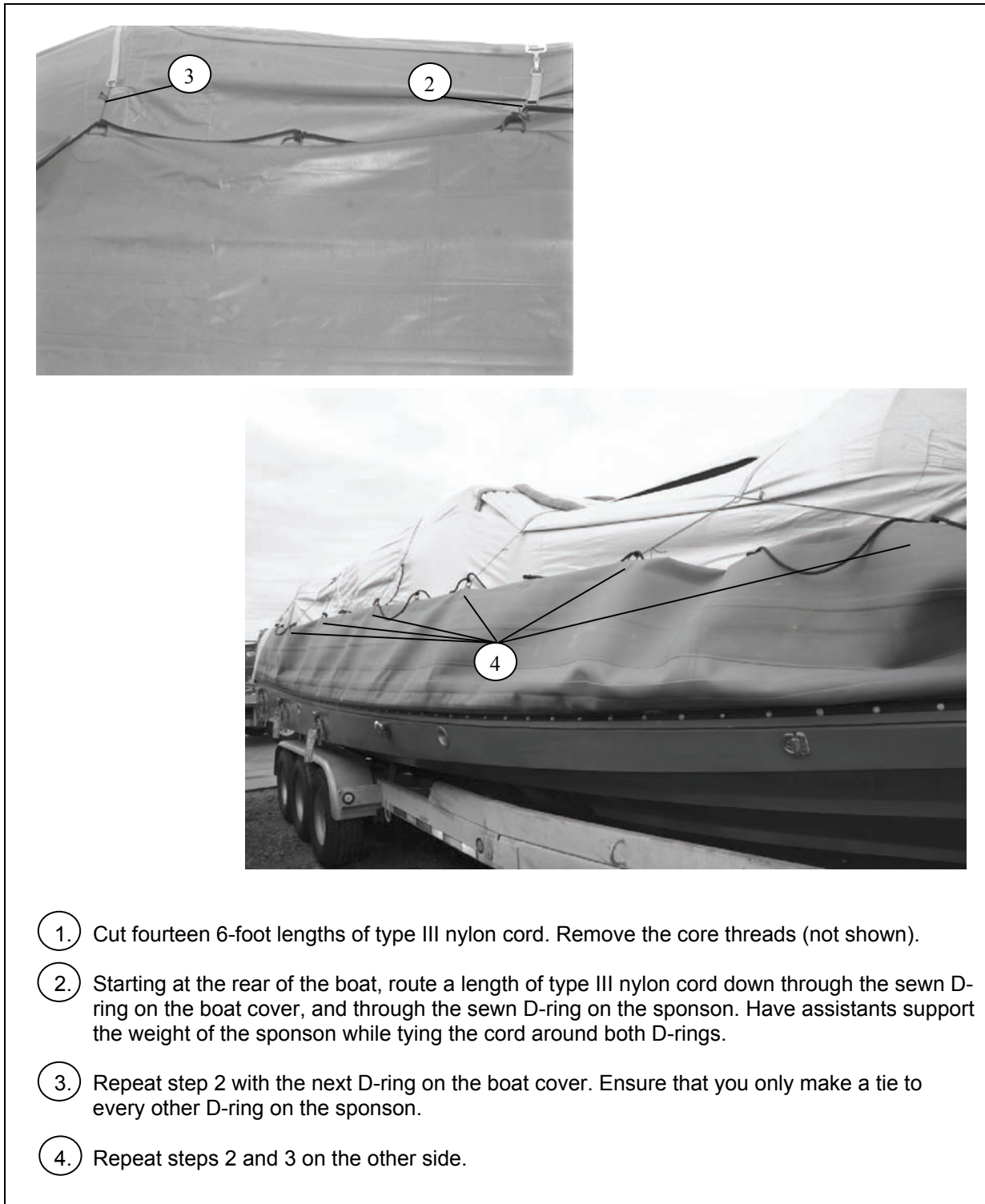
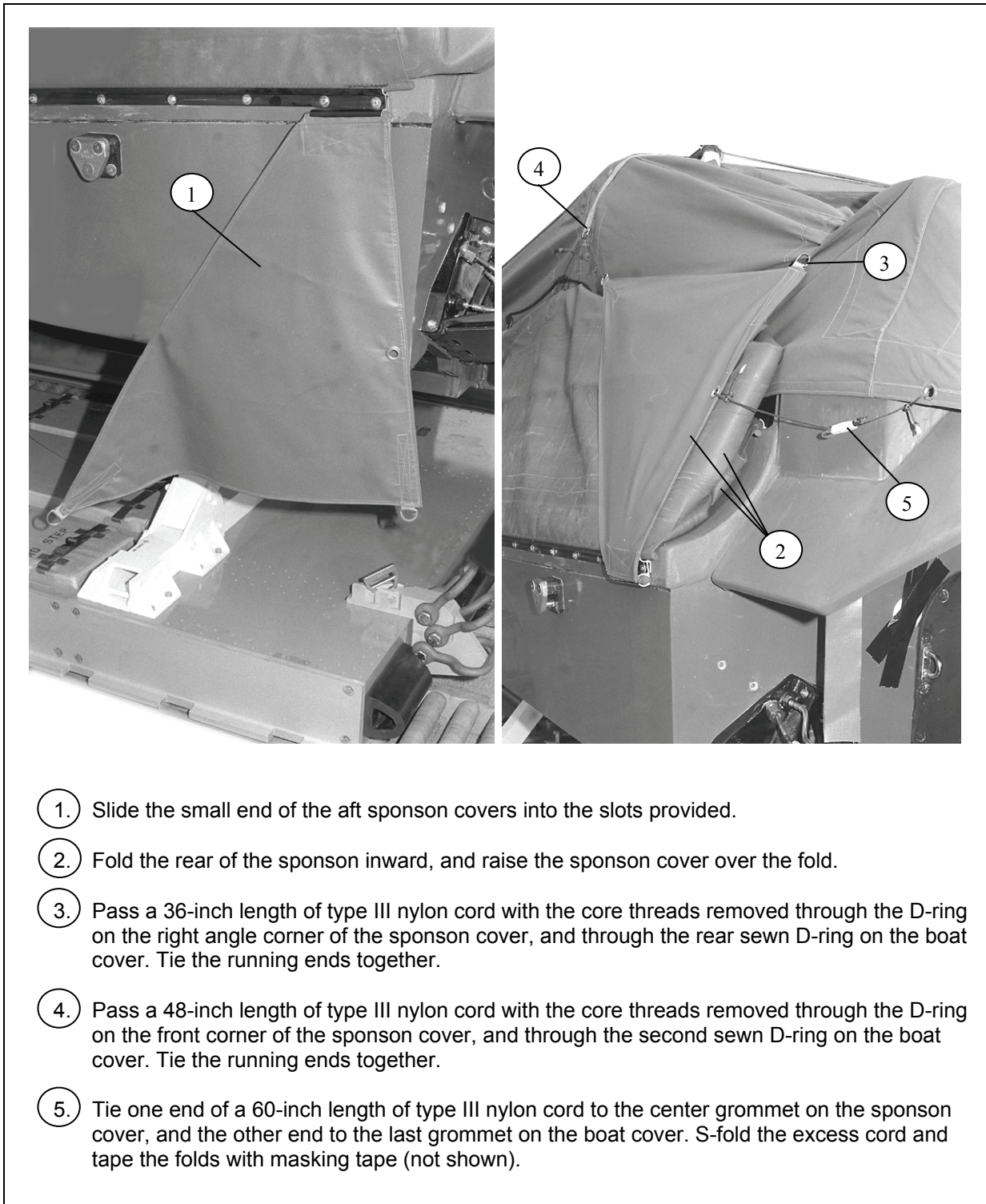

Figure 4-19. Boat Cover Installed (continued)



1. Cut fourteen 6-foot lengths of type III nylon cord. Remove the core threads (not shown).
2. Starting at the rear of the boat, route a length of type III nylon cord down through the sewn D-ring on the boat cover, and through the sewn D-ring on the sponson. Have assistants support the weight of the sponson while tying the cord around both D-rings.
3. Repeat step 2 with the next D-ring on the boat cover. Ensure that you only make a tie to every other D-ring on the sponson.
4. Repeat steps 2 and 3 on the other side.

Figure 4-20. Sponsons Tied



1. Slide the small end of the aft sponson covers into the slots provided.
2. Fold the rear of the sponson inward, and raise the sponson cover over the fold.
3. Pass a 36-inch length of type III nylon cord with the core threads removed through the D-ring on the right angle corner of the sponson cover, and through the rear sewn D-ring on the boat cover. Tie the running ends together.
4. Pass a 48-inch length of type III nylon cord with the core threads removed through the D-ring on the front corner of the sponson cover, and through the second sewn D-ring on the boat cover. Tie the running ends together.
5. Tie one end of a 60-inch length of type III nylon cord to the center grommet on the sponson cover, and the other end to the last grommet on the boat cover. S-fold the excess cord and tape the folds with masking tape (not shown).

Figure 4-21. Aft Sponson Covers Tied

PREPARING SUSPENSION SLINGS

4-10. Raise and safety the suspension slings as shown in Figure 4-22.

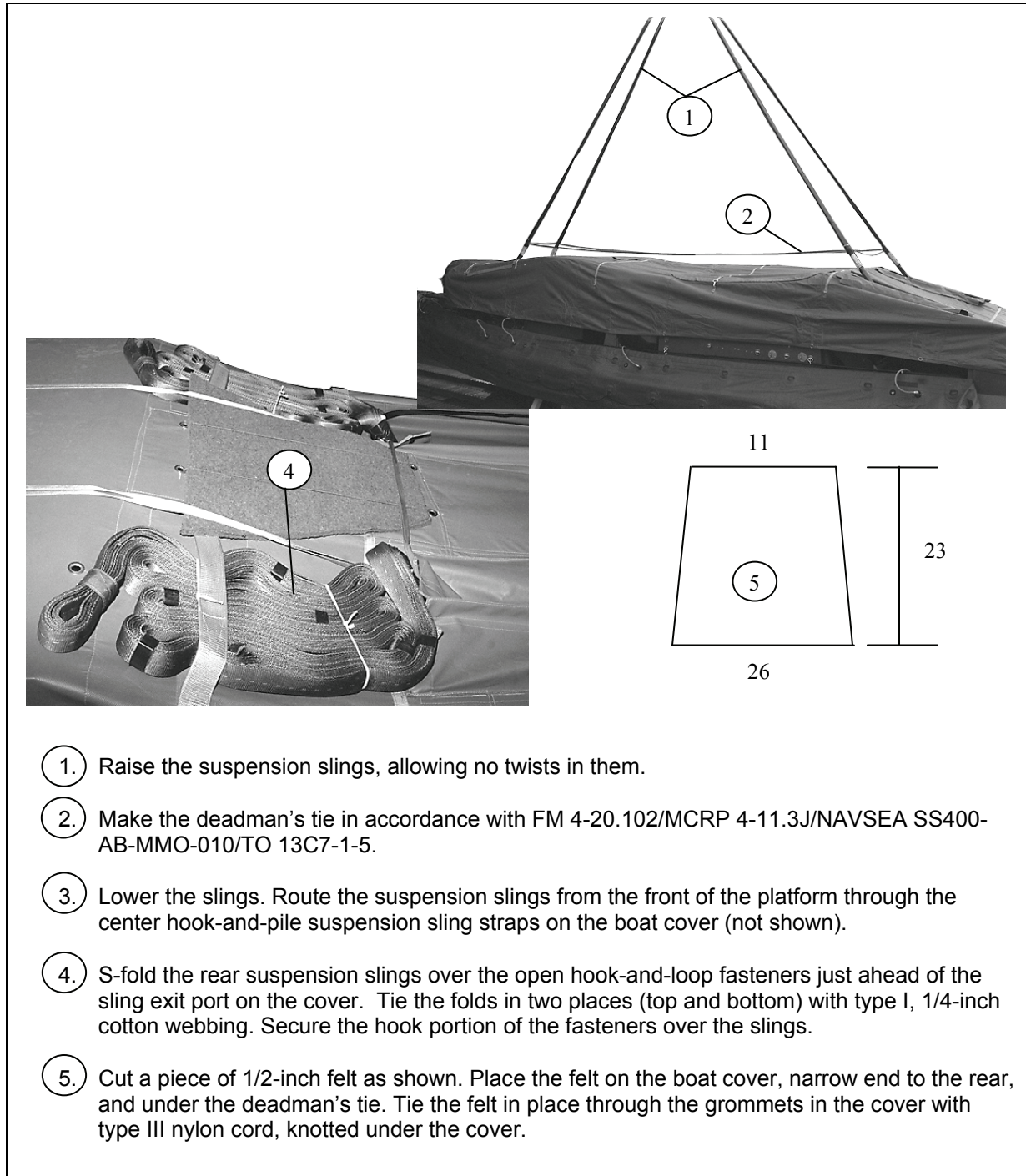

1. Raise the suspension slings, allowing no twists in them.
2. Make the deadman's tie in accordance with FM 4-20.102/MCRP 4-11.3J/NAVSEA SS400-AB-MMO-010/TO 13C7-1-5.
3. Lower the slings. Route the suspension slings from the front of the platform through the center hook-and-pile suspension sling straps on the boat cover (not shown).
4. S-fold the rear suspension slings over the open hook-and-loop fasteners just ahead of the sling exit port on the cover. Tie the folds in two places (top and bottom) with type I, 1/4-inch cotton webbing. Secure the hook portion of the fasteners over the slings.
5. Cut a piece of 1/2-inch felt as shown. Place the felt on the boat cover, narrow end to the rear, and under the deadman's tie. Tie the felt in place through the grommets in the cover with type III nylon cord, knotted under the cover.

Figure 4-22. Suspension Slings Safetied and Stowed

INSTALLING PARACHUTE STOWAGE PLATFORM

4-11. Tie the front sponsons, and install the parachute stowage platform as shown in Figure 4-23.

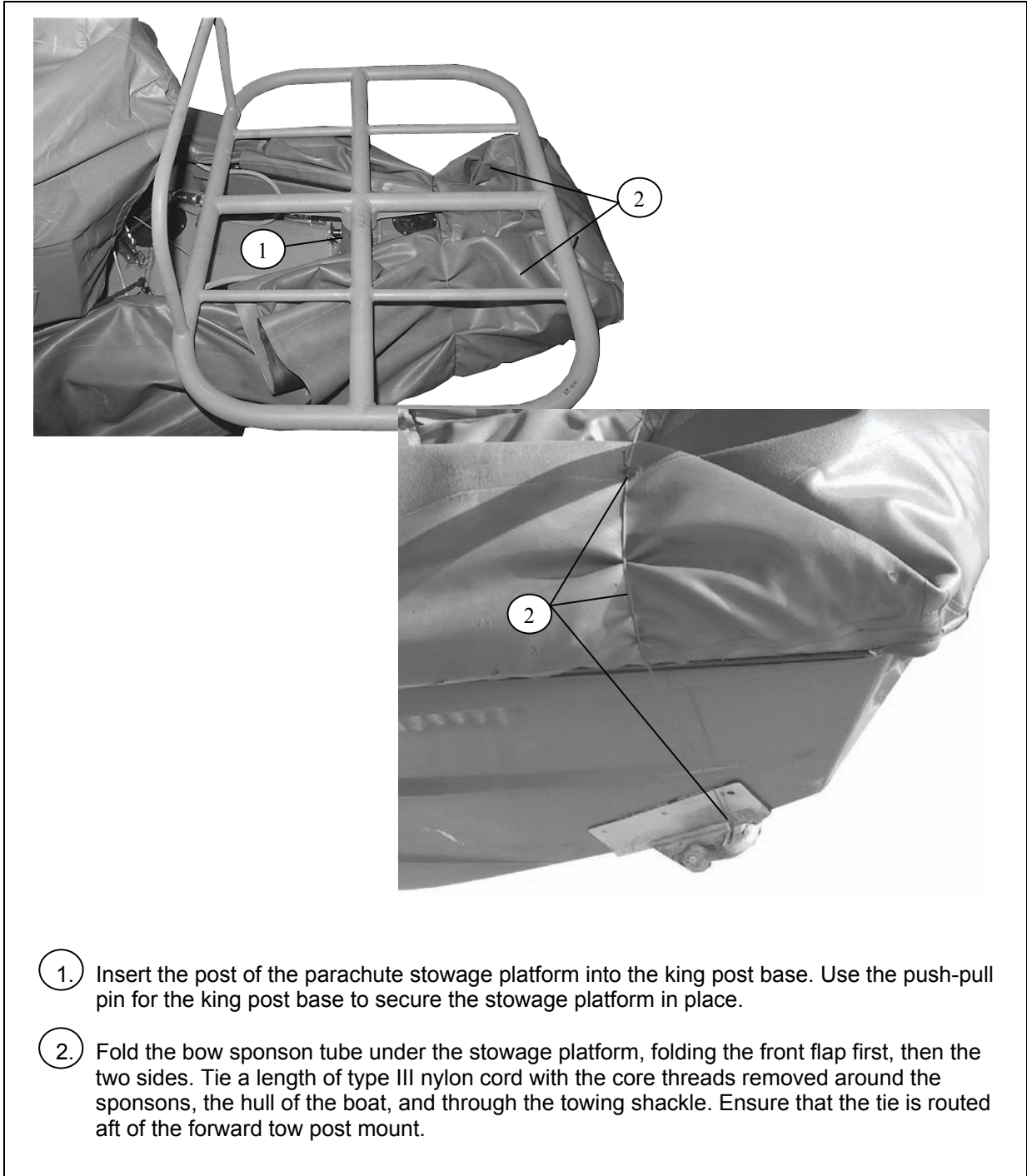

Figure 4-23. Front Sponsons Folded and Parachute Stowage Platform Installed

INSTALLING CARGO PARACHUTES

4-12. Install four G-11 cargo parachutes according to FM 4-20.102/MCRP 4-11.3J/NAVSEA SS400-AB-MMO-010/TO 13C7-1-5 and as shown in Figure 4-24.

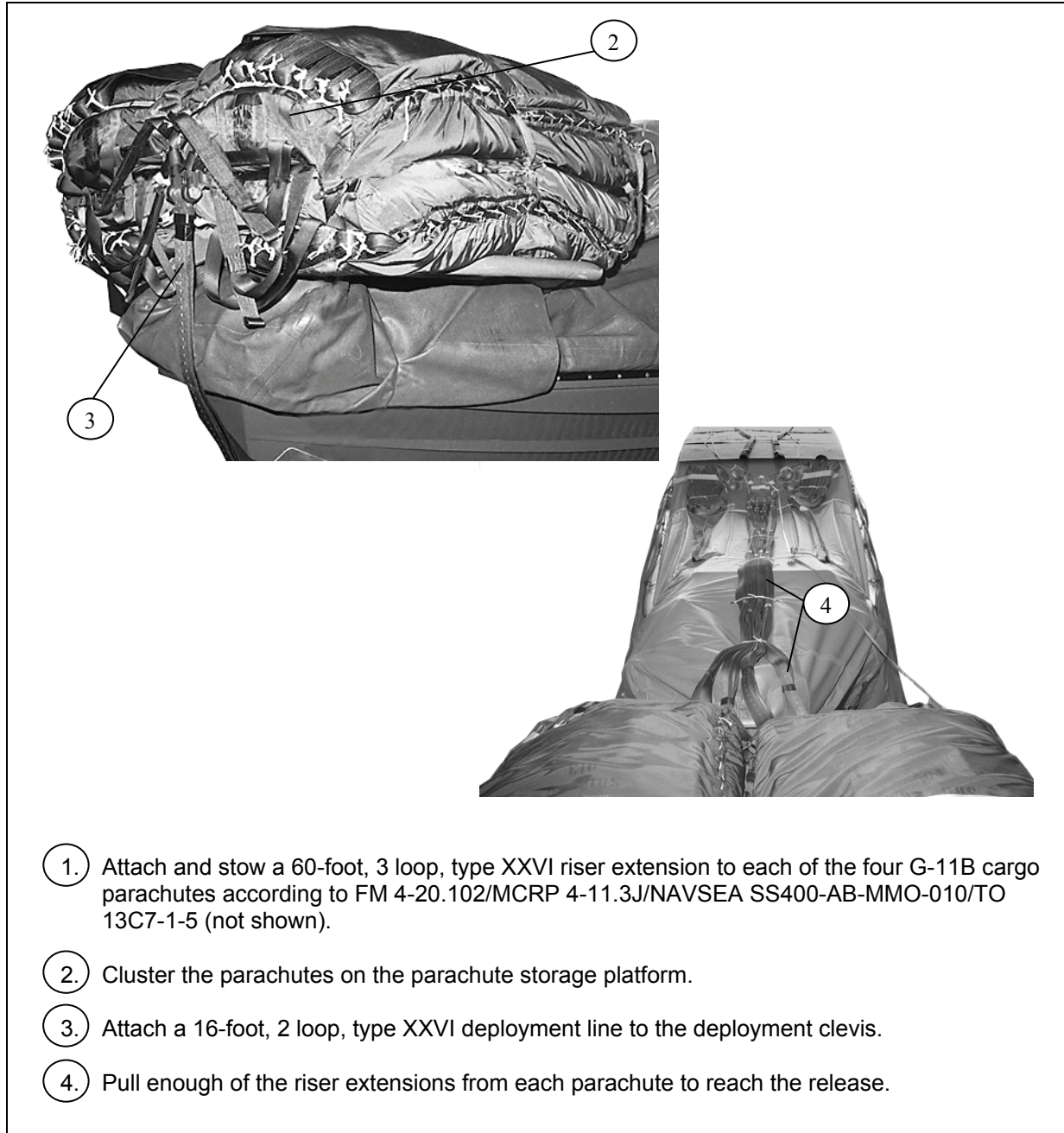

Figure 4-24. Cargo Parachutes Installed

INSTALLING M-2 CARGO PARACHUTE RELEASE

4-13. Prepare and install an M-2 cargo parachute release according to FM 4-20.102/MCRP 4-11.3J/NAVSEA SS400-AB-MMO-010/TO 13C7-1-5, and as shown in Figure 4-25.

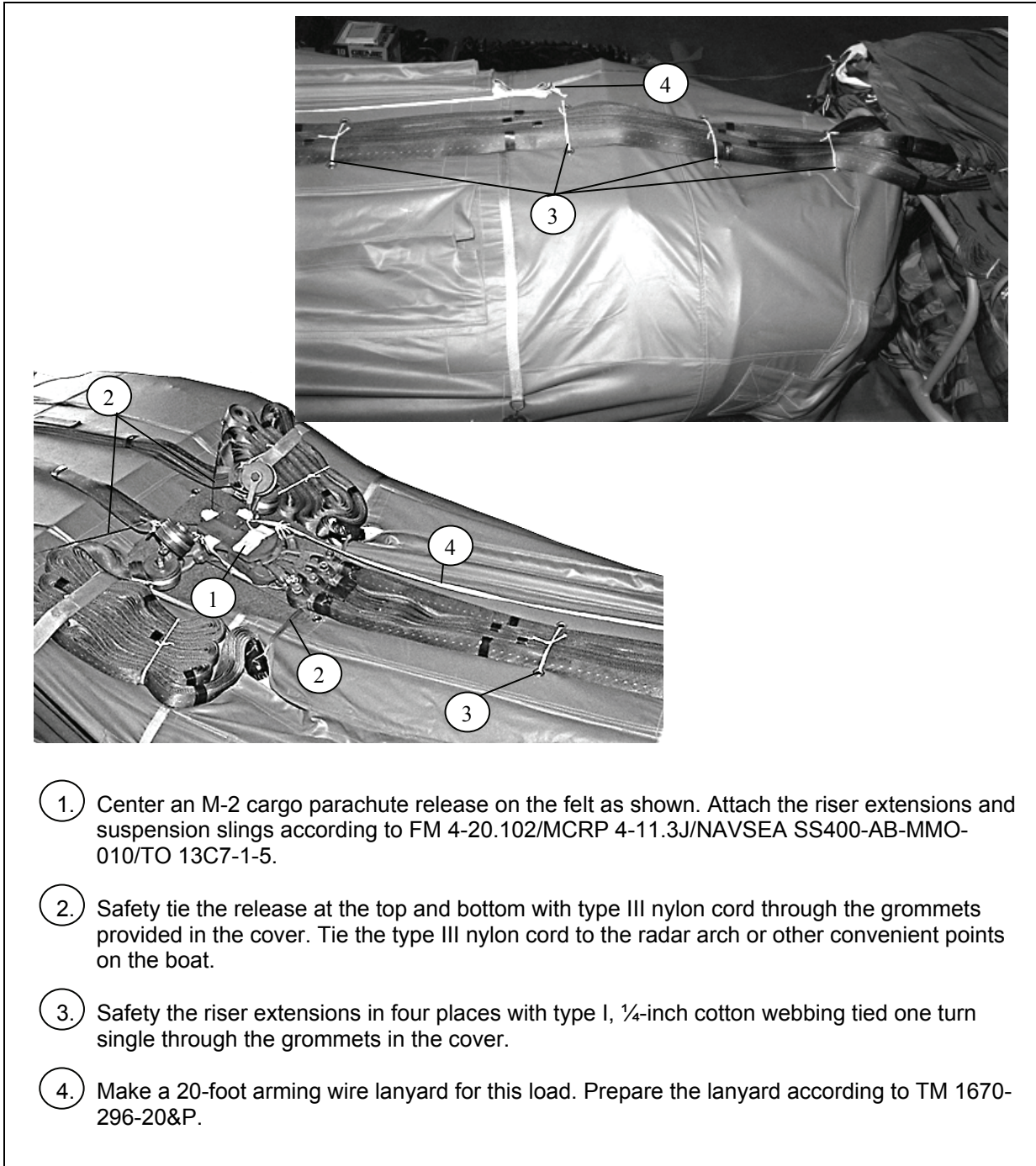

Figure 4-25. M-2 Cargo Parachute Release Installed

INSTALLING PARACHUTE RESTRAINTS

4-14. Restrain the cargo parachute according to FM 4-20.102/MCRP 4-11.3J/NAVSEA SS400-AB-MMO-010/TO 13C7-1-5 and as shown in Figure 4-26.

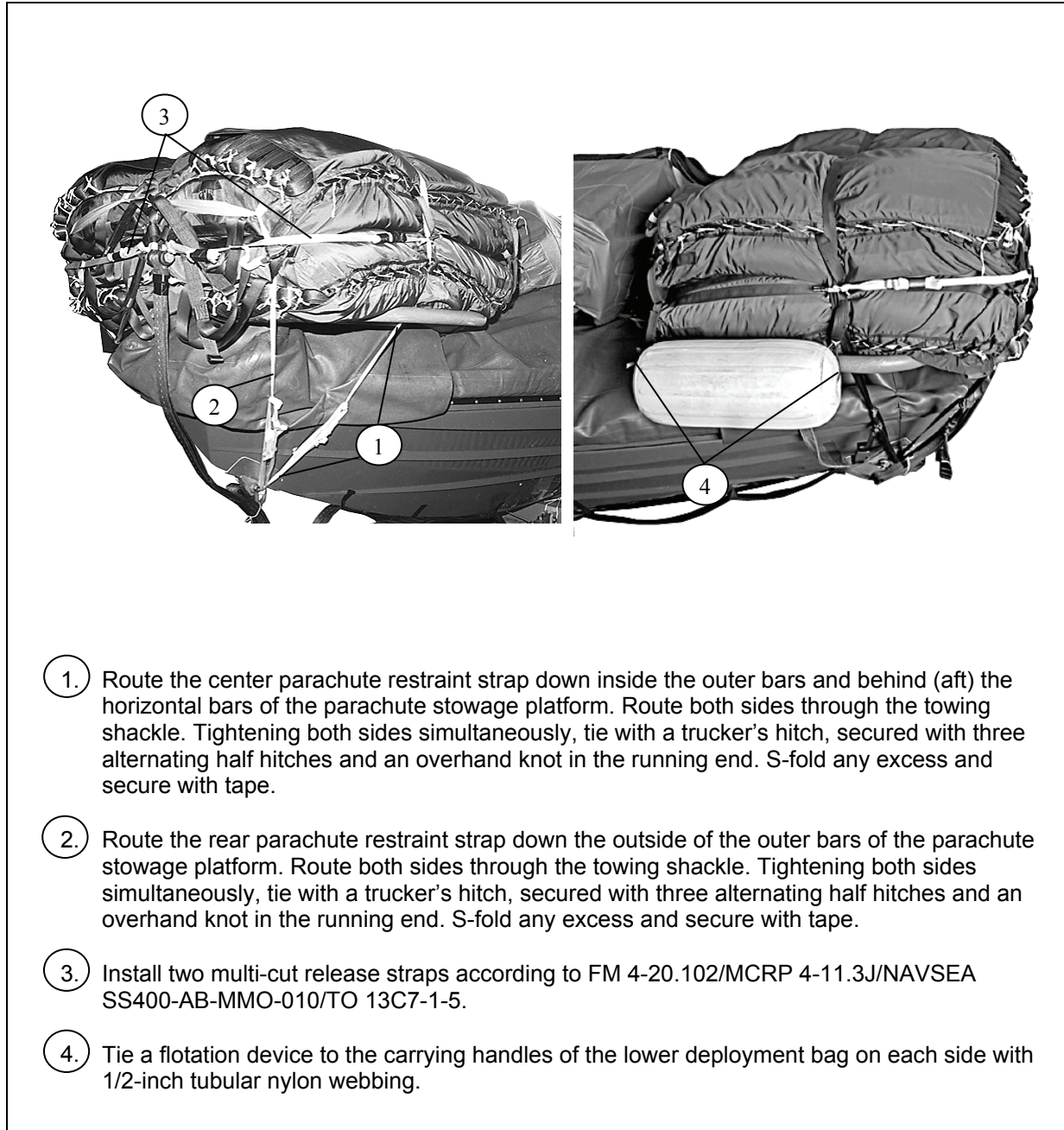
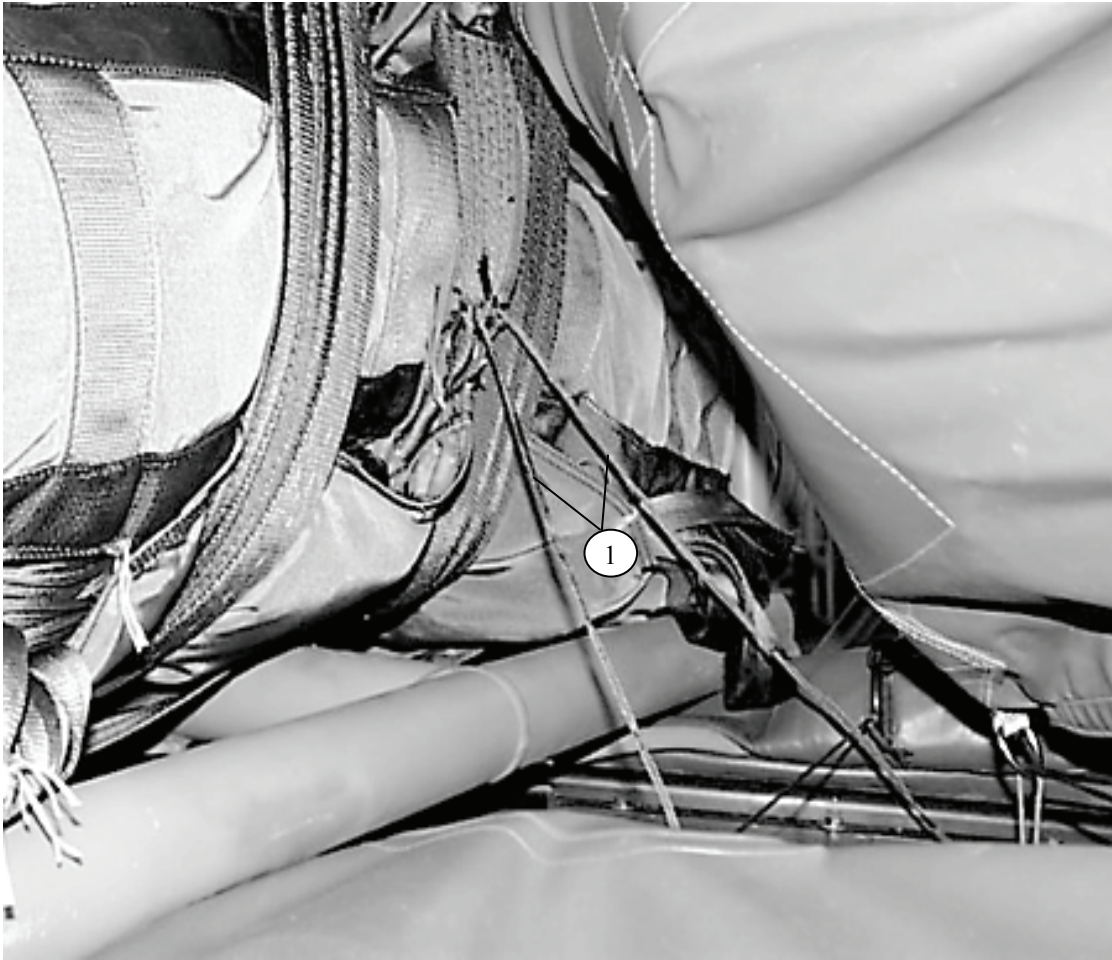

Figure 4-26. Cargo Parachutes Restrained

INSTALLING SPONSON ACTIVATION LANYARD

4-15. Install the sponson activation lanyard as shown in Figure 4-27.



1. Pass the sponson inflation lanyards installed in Figure 4-17 over all items and route through the bottom center carrying handle of the G-11 parachute. Remove the slack between the sponson activation cable ring and the G-11 carrying handles, but do not pull taut. Tie each lanyard to the bottom carrying handle of the G-11 cargo parachute with three alternating half hitches and an overhand knot in the running end. Cut off any excess.

Figure 4-27. Sponson Activation Lanyard Installed